

27 Coed Celyn, Abergele, LL22 7EN

£195,000

🛏 2 🚿 1 🚗 1



New to the market this beautifully refurbished, semi detached bungalow. Benefiting from no onward chain and offering views of the Tan-Y-Gopa woodlands. Comprising of Two double bedrooms, modernized kitchen, spacious lounge with feature fireplace and Three piece bathroom suite. A bricked driveway allows ample space for off-street parking with gardens to the front and rear along with a detached single garage. Located close to Abergele Golf Course and within minutes walk to the town centre of Abergele where amenities are easily accessed.

Key Features

- Semi-detached bungalow
- Two Bedrooms
- Detached garage
- Fully refirbished
- Modernized
- Views of the woodlands
- Within minutes walk to the town centre
- Tenure - Freehold
- Council Tax Band - C
- EPC - C

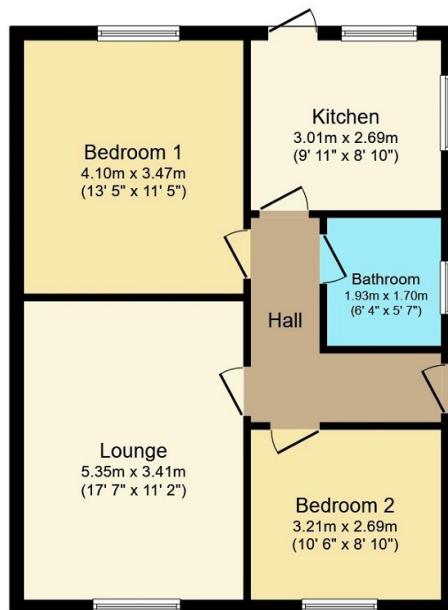

Floor Plan

Floor area 58.0 sq.m. (624 sq.ft.) approx

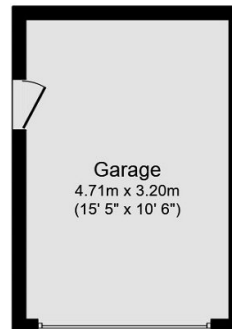

Garage

Floor area 15.1 sq.m. (162 sq.ft.) approx

Total floor area 73.0 sq.m. (786 sq.ft.) approx

This plan is for illustration purposes only and may not be representative of the property. Plan not to scale.